



QUILLIAM

London Road
Isleworth

- No Onward Chain
- Period Property
- Two Bedroom Conversion
- Bright Reception room
- Fitted Kitchen
- Private Garden
- Modern Finish
- Transport Links
- Isleworth Station Circa 7 Min Walk
- Local Shops & Other Amenities

£450,000

**Share of
Freehold**





Property Description

Quilliam are delighted to present this stylish modern apartment located on London Road.

This beautifully presented upper flat boasts a sleek grey interior that gives the space a fresh, contemporary feel. With two spacious bedrooms and a well-appointed bathroom, it's the perfect blend of comfort and modern living. The open-plan living area is bright and airy, creating a welcoming environment whether you're unwinding after a long day or hosting friends.

Situated in a fantastic location on London Road, you're just moments away from a variety of local shops, cafes, and restaurants, making day-to-day life easy and convenient. Commuters will appreciate the excellent transport links close by, while those who love the outdoors will enjoy the nearby green spaces for walks and weekend relaxation.

Ideal for first-time buyers, professionals, or investors looking for a move-in ready home with great potential. This lovely apartment offers a fantastic opportunity to settle into a vibrant community with everything you need right on your doorstep.

Disclaimer

Information provided in this listing is for general guidance only and should be verified before proceeding. We have not tested any fixtures, fittings, services, or appliances. Measurements are approximate, and the photographs are intended solely as an illustrative guide. The details have been supplied by the client, and we rely on their accuracy.

Accommodation

Reception Room

15'4" x 10'5"

Entrance

13'6" x 7'4"

Kitchen

13'3" x 10'9"

Bedroom One

12'5" x 10'7"

Bedroom Two

9'3" x 5'8"

Bathroom

7'4" x 7'3"



Property Information

We have been informed by our Vendor of the following information:

Tenure: Share of Freehold

Term of Lease: 999 years from 16/11/2021 (approximately 994 years remaining)

London Borough of Hounslow Council Tax Band: D

Council Tax Payable for 2026/27 £2,189.83 per annum

The annual Council Tax charge has been supplied in good faith and is for the period 2026/27. It will likely be reviewed and changed by the Local Authority the following year and could be subject to an increase after the end of March.

Parking: Shared Driveway



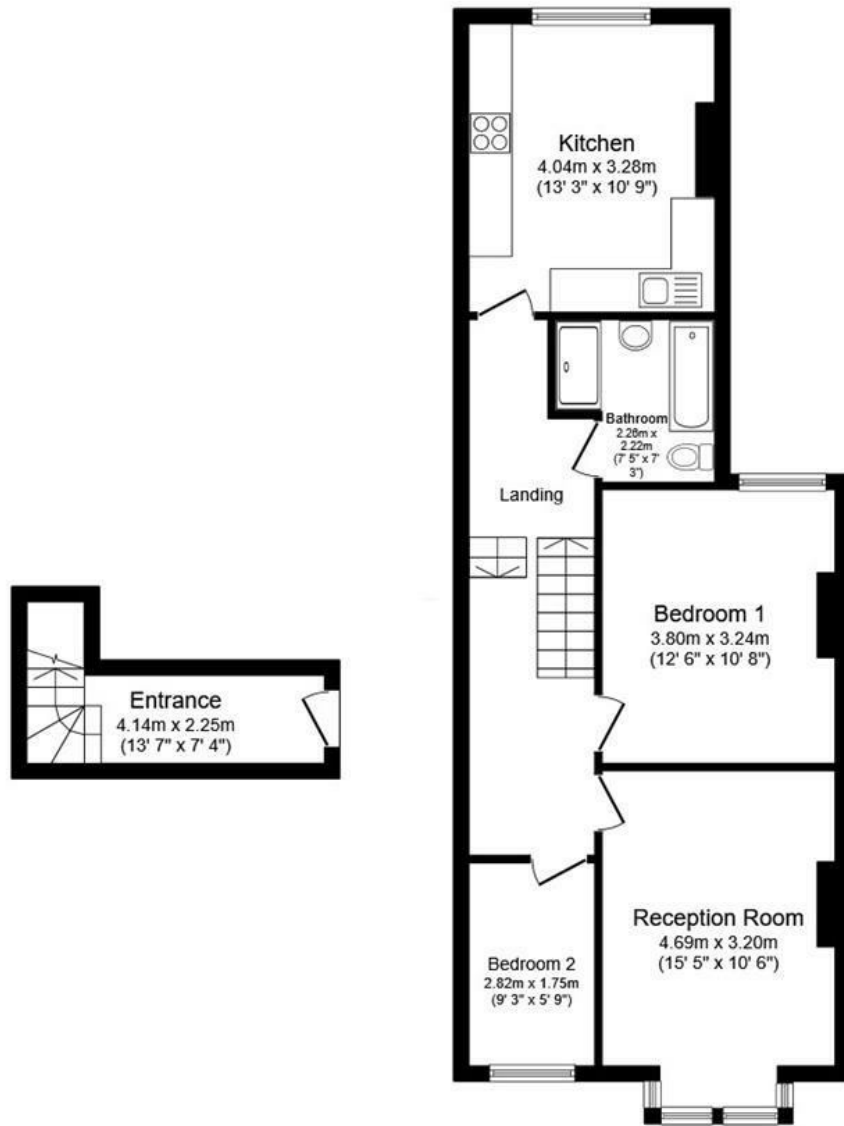

Ground Floor
Floor area 5.9 sq.m. (63 sq.ft.)

First Floor
Floor area 63.8 sq.m. (686 sq.ft.)

Total floor area: 69.6 sq.m. (750 sq.ft.)

This floor plan is for illustrative purposes only. It is not drawn to scale. Any measurements, floor areas (including any total floor area), openings and orientations are approximate. No details are guaranteed, they cannot be relied upon for any purpose and do not form any part of any agreement. No liability is taken for any error, omission or misstatement. A party must rely upon its own inspection(s). Powered by www.Propertybox.io



Energy Efficiency Rating		Current	Potential
Very energy efficient - lower running costs			
(92 plus) A			
(81-91) B			
(69-80) C			
(55-68) D			
(39-54) E			
(21-38) F			
(1-20) G			
Not energy efficient - higher running costs			
		69	76
England & Wales		EU Directive 2002/91/EC	



206 High Street
Brentford
TW8 8AH

020 8847 4737
info@quilliam.co.uk
<https://www.quilliam.co.uk>

Agents Note: Whilst every care has been taken to prepare these particulars, they are for guidance purposes only. All measurements are approximate and are for general guidance purposes only and whilst every care has been taken to ensure their accuracy, they should not be relied upon and potential buyers/tenants are advised to recheck the measurements